

# Standalone Presence Detectors

Exceptional lighting control solutions



Brochure  
Issue **1.5**



## Contents

### Infrared Handsets



#### UNLCDHS

Professional programming/  
commissioning LCD handset

4



#### UHS5

Compact programming/  
commissioning handset

4



#### UHS7

Compact user handset

4

### PIR Presence Detectors



#### EBDSPIR

Compact, flush mounted detectors

5



#### EBDSM

Compact, surface mounted  
detectors

6



#### EBDMR

Mid range, flush mounted detectors

7



#### EBMHS

Miniature, flush/surface mounted  
detectors

8



#### EBMPIR-MB

Miniature, retrofit, luminaire  
mounted detectors

9



#### EBDRC

Long range, adjustable head,  
flush mounted detectors

10

## We can offer building-wide control.

Our wide range of presence detectors are designed to reduce the amount of time lighting or HVAC equipment is left on unnecessarily – for example if an area is unoccupied or if there is sufficient natural light.

Controlling lighting with a presence detector can save up to 60% of lighting energy usage dependent on occupancy behaviour and the amount of natural light available. Selected PIR and microwave presence detectors can also be used to control heating and ventilation.

In our range you are sure to find a presence detector that will suit any space.





## PIR Presence Detectors



### EBDHS

High bay/high level, flush mounted detectors

11



### EBDHS-MB

High bay/high level, luminaire mounted detectors

12

## Air Conditioning Controller



### GESM-AC

Surface mounted controller for air conditioning

13

## Microwave Presence Detectors



### MWS3A

Adjustable head, long range, flush mounted detectors

14



### MWS5

Compact, flush/surface mounted detectors

15



### MWS6

Compact, flush mounted detectors

16



### MWS6SM

Compact, surface mounted detectors

17



### MWS1A

Low profile, back box mounted detectors

18



### MWS1A-IP

Rugged, surface mounted detectors

19

## Light Level Controls



### ALC

Compact, flush mounted switching and dimming photocells

20

## Product Spotlight



Low Temperature detectors

21



KNX presence detectors

21

## Technology Guide

Presence and absence detection explained

22

PIRs and microwave detectors compared

23

Walk towards & walk across explained (PIR Detectors)

23

PRM detectors – switching with lux level sensing

24

DD & AD detectors – dimming with lux level sensing

25

## Order Codes

26

## Infrared Handsets

Our range of infrared (IR) handsets have been designed to allow simple configuration, programming and maximum user convenience.

There's a handset to suit every user, whether it's the commissioning engineer configuring hundreds of detectors, a contractor setting up two or three, or a user who simply wishes to override a setting or switch between pre-programmed scenes.



UNLCDHS

### UNLCDHS – Professional commissioning LCD programming handset

- The UNLCDHS is used for the operation, configuration and programming of CP products that have the ability to be programmed via IR. These include the PRM, DD, AD, Vitesse Plus, RAPID, D-Mate and An-10 ranges.
- Infrared range up to 20m.



UHS5



UHS7

### UHS5 – Commissioning handset

- The UHS5 is a compact infrared handset used for the basic programming of IR enabled CP products
- Infrared range up to 7m.

### UHS7 – User handset

- User handset for simple scene setting, on & off, raise & lower
- Infrared range up to 7m.

## EBDSPIR | Compact, flush mounted detectors



This compact ceiling mounted PIR presence detector provides automatic control of lighting, heating and ventilation loads.

- Low profile design
- Self contained unit
- Pluggable
- Programme time delay and lux settings via infrared handset (excluding Basic variant).
- Available in a wide range of RAL colours
- 5 year warranty.

### Available control methods

- B – Basic switching
- PRM – Switching
- DD – DALI/DSI dimming
- AD – Analogue dimming
- KNX – See page 22

### Special order variants

- LT30 – Low temperature
  - LV – Low voltage
  - VFC – Voltage free contact
  - 2CH – 2 channel
- Additional variants available – please see our website.

### Detection pattern

high < sensitivity > low

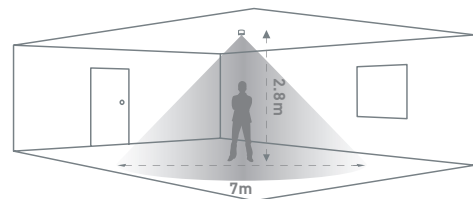

### Dimensions (mm)

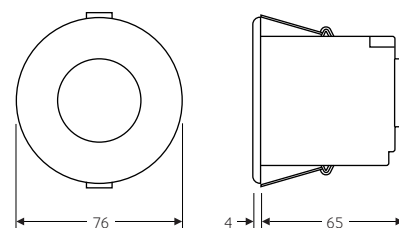

## EBDSM | Compact, surface mounted detectors



This series of surface mounted PIR presence/absence detectors is perfect for simple attachment when flush mounting is not possible.

- Self contained unit
- Easy to install via back plate
- Programme time delay and lux settings via infrared handset
- IP40 (no gasket); IP54 when fitted with gasket
- 5 year warranty.

### Available control methods

- PRM – Switching
- DD – DALI/DSI dimming
- AD – Analogue dimming

### Detection pattern

high < sensitivity > low

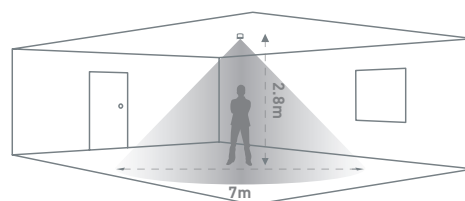

### Dimensions (mm)

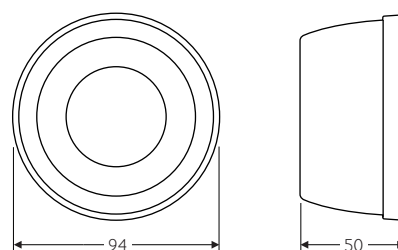



## EBDMR | Mid range, flush mounted detectors



Our series of compact flush mounted PIR presence/absence detectors with high performance faceted lens is suitable for use in open spaces or where a larger detection range is required.

- Mid range lens with concentric lens facets for improved detection
- Ideal for open spaces
- Programme time delay and lux settings via infrared handset
- IP40 rated
- Available in a wide range of RAL colours
- 5 year warranty.

### Available control methods

- PRM – Switching
- DD – DALI/DSI dimming
- AD – Analogue dimming

### Special order variants

- LV – Low voltage
- Additional variants available to special order – please see our website.

### Detection pattern

high < sensitivity > low

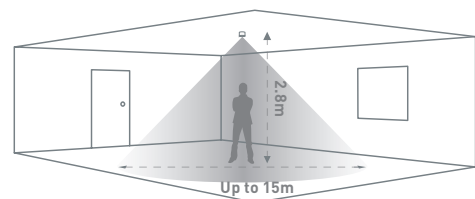

### Dimensions (mm)

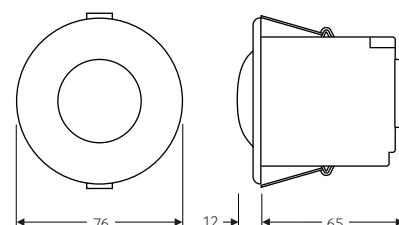

## EBMHS | Miniature, flush/surface mounted detectors



This small, unobtrusive, but highly capable PIR presence/absence detector is supplied pre-wired and with a connector that snap-fits into the power supply unit (PSU) for ease of installation.

- Small and unobtrusive design
- High sensitivity head for increased detection range
- Programme time delay and lux settings via infrared handset
- Supplied pre-wired with an RJ11 plug for connection into the power supply
- Supplied with a flush mounting ring for easy fitting into the ceiling.
- Available with standard or slim line PSU
- 5 year warranty.

### Available control methods

- PRM – Switching
- DD – DALI/DSI dimming
- AD – Analogue dimming

### Special order variants

- LV – Low voltage

### Detection pattern

high < sensitivity > low

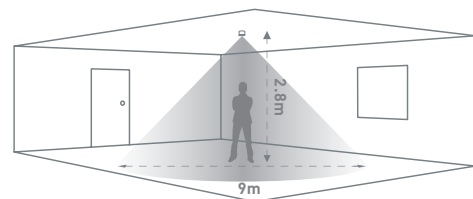

### Dimensions (mm)

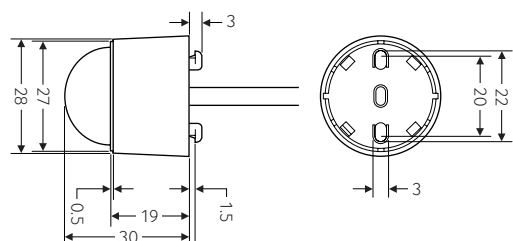



## EBMPIR-MB | Miniature, retrofit, luminaire mounted detectors



The EBMPiR-MB series of batten mount PIR presence detectors have been designed specifically for mounting on to a batten style luminaire.

- Batten mount retrofit solution
- Integrated power supply
- Suitable for a wide range of luminaires
- Pre wired with 1m cable
- Programme time delay and lux settings via infrared handset
- IP65 rated for wet and damp environments
- For mounting at heights up to 7m
- 5 year warranty.

### Available control methods

- PRM – Switching
- DD – DALI/DSI dimming
- AD – Analogue dimming

### Special order variants

- LT30 – Low temperature
- LV – Low voltage (110V)

### Detection pattern

high < sensitivity > low

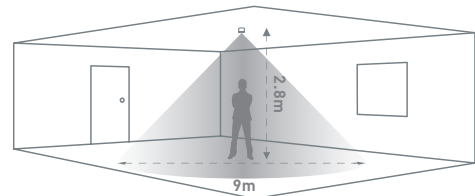

### Dimensions (mm)

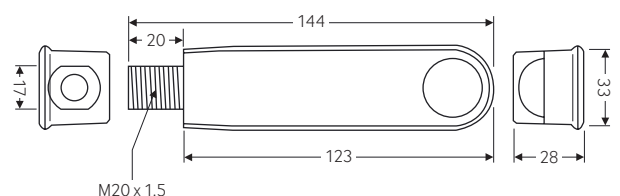

## EBDRC | Long range, adjustable head, flush mounted detectors



**Head can be adjusted to suit the detection pattern required**



Detection head position set to 15°



Detection head position set to 90°



The EBDRC series of PIR presence/absence detectors contains an adjustable head, and is fitted with a curtain lens for long range detection. Our directional PIR is suitable for mounting in aisleway and corridor applications where a long narrow detection pattern is required.

- Adjustable head
- Curtain lens for longer detection range
- Programme time delay and lux settings via infrared handset
- IP40 rated
- Ideal for corridor applications
- 5 year warranty.

### Available control methods

- PRM – Switching
- DD – DALI/DSI dimming
- AD – Analogue dimming

### Special order variants

Additional variants available to special order – please see our website.

### Detection pattern

high < sensitivity > low

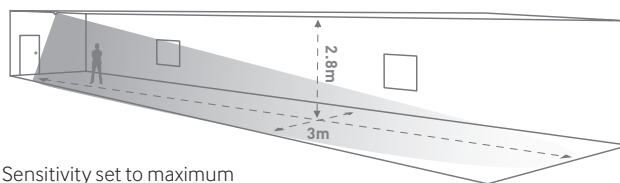

Sensitivity set to maximum  
Detector head position set to 90°

Range	
Walk towards	10m
Walk across	24m

See page 23 for Walk towards and Walk across explained.

### Dimensions (mm)

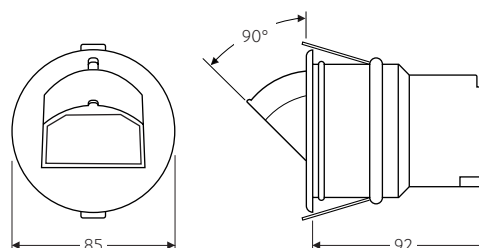

## EBDHS | High bay/high level, flush mounted detectors



The EBDHS PIR presence/absence detector is developed for lighting control in areas with demanding spaces and increased mounting heights.

- Ground breaking detection range
- For mounting at heights up to 20m depending on operating parameters
- Unique lens technology – high sensitivity
- Ideal for high level/high bay applications
- Programme time delay and lux settings via infrared handset
- Supplied with adjustable masking shields to tailor detection zones
- 5 year warranty.

### Available control methods

- PRM – Switching
- DD – DALI/DSI dimming
- AD – Analogue dimming
- KNX – See page 22

### Special order variants

- LT30 – Low temperature
- LV – Low voltage

### Detection pattern

high < sensitivity > low

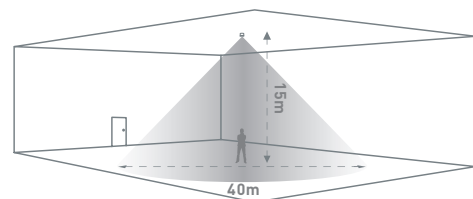

### Dimensions (mm)

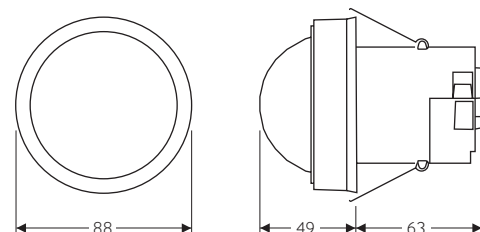



## EBDHS-MB | High bay/high level, luminaire mounted detectors



PATENTED  
DESIGN

The EBDHS-MB luminaire mounted PIR presence detector series provides exceptionally sensitive and long range detection. Ideal for high bay lighting control in areas with demanding spaces and increased mounting heights.

- Ground breaking detection range
- For mounting at heights up to 20m depending on operating parameters
- Unique lens technology – high sensitivity
- Ideal for high level/high bay applications
- Programme time delay and lux settings via infrared handset
- Easy to retrofit to commercial luminaires and basic battens
- 5 year warranty.

### Available control methods

- PRM – Switching
- DD – DALI/DSI dimming
- AD – Analogue dimming

### Special order variants

- LT30 – Low temperature

### Detection pattern

high < sensitivity > low

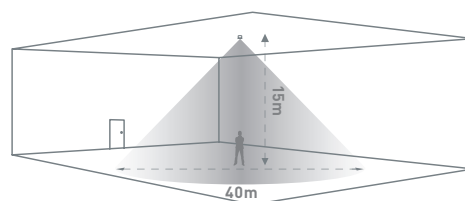

### Dimensions (mm)

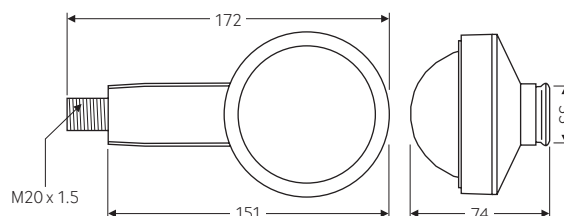

## GESM-AC | Surface mounted controller for air conditioning



This AC unit simply 'learns' an AC unit's infrared code, then controls its operation, based on occupancy. As it is surface mounted and battery powered, installation is simplified and disruption is reduced.

- Compatible with most infrared controlled AC units
- Battery operated
- Presence detection - auto on, auto off
- Adjust time delay settings via push buttons
- Lockable settings
- Sleep mode extends battery life
- 5 year warranty.

### Detection pattern

high < sensitivity > low

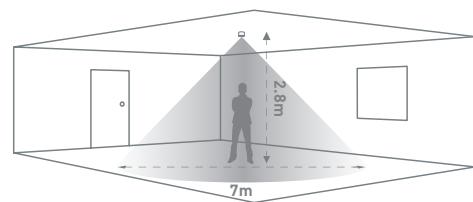

### Dimensions (mm)

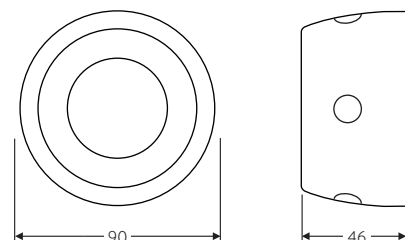

## MWS3A | Adjustable head, long range, flush mounted detectors



Unlike fixed head microwave detectors, the MWS3A series of presence/absence detectors offers a unique adjustable head to suit the required detection pattern.

- Unique adjustable head design to achieve the required detection pattern
- Locking mechanism to prevent tampering
- Can be flush or surface mounted
- Programme time delay and lux settings via infrared handset
- IP40 rated
- 5 year warranty.

### Available control methods

- PRM – Switching
- DD – DALI/DSI dimming
- AD – Analogue dimming
- KNX – See page 22

### Special order variants

- LV – Low voltage
- VFC – Voltage free contact
- VFC NC – Voltage free contact normally closed
- 2CH – 2 channel
- 2CH-NC – 2 channel normally closed

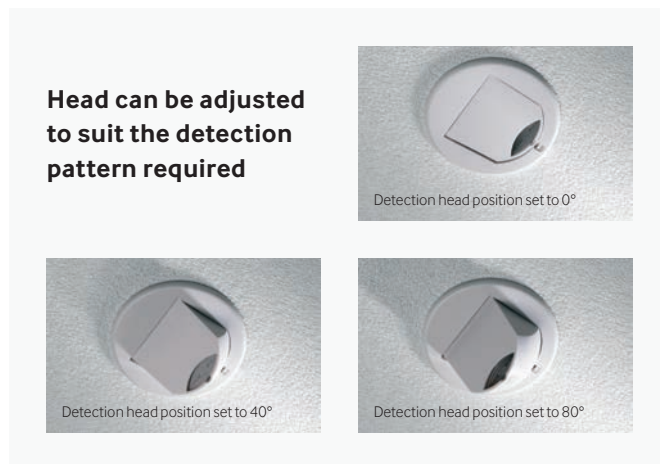

### Detection pattern

high < sensitivity > low

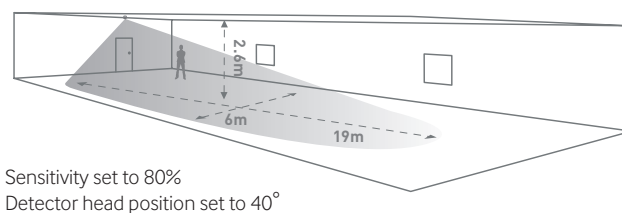
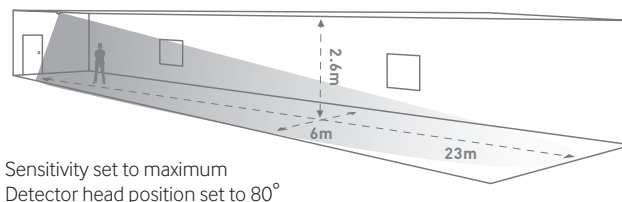
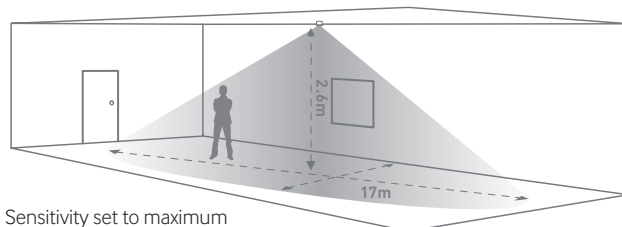

### Dimensions (mm)

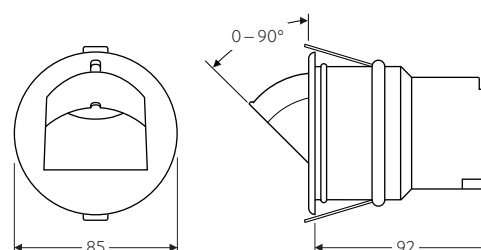



## MWS5 | Compact, flush/surface mounted detectors



The MWS5 series of compact microwave presence/absence detectors has been specifically designed to be mounted within a luminaire. They are sensitive to movement and are ideal for large spaces that have an awkward shape.

- Can be flush or surface mounted
- Remote power supply allows head to be fitted in confined spaces
- Suitable for wall or ceiling mounted luminaires
- A selection of fixing clips to allow the unit to be mounted in or to the side of a luminaire is available
- Programme time delay and lux settings via infrared handset
- Standard and slimline power supply units also available
- 5 year warranty.

### Available control methods

- PRM – Switching
- DD – DALI/DSI dimming
- AD – Analogue dimming

### Detection pattern

high < sensitivity > low

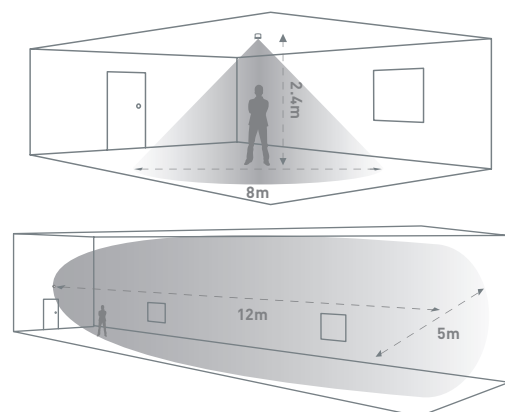

### Dimensions (mm)

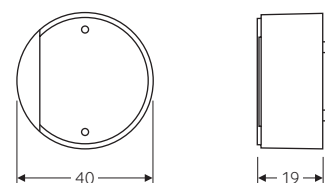

For power supply unit dimensions, please refer to the product installation guide on our website.

## MWS6 | Compact, flush mounted detectors



The MWS6 is a low profile microwave presence/absence detector for the automatic control of lighting, heating and ventilation.

- Low profile design
- Self contained unit
- Pluggable
- IP40 rated
- Programme time delay and lux settings via infrared handset
- Available in a wide range of RAL colours
- 5 year warranty.

### Available control methods

- PRM – Switching
- DD – DALI/DSI dimming
- AD – Analogue dimming
- KNX – See page 22

### Special order variants

- LV – Low voltage
  - VFC – Voltage free contact
  - 2CH – 2 channel
- Additional variants available to special order – please see our website.

### Detection pattern

high < sensitivity > low

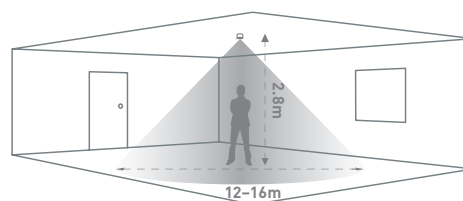

### Dimensions (mm)

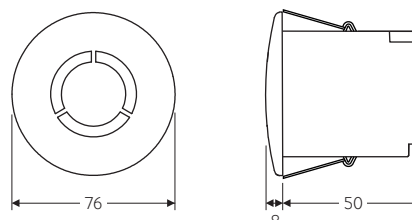

## MWS6SM | Compact, surface mounted detectors



The MWS6SM is a surface mounted mid-range microwave presence/absence detector for the automatic control of lighting, heating and ventilation.

- Surface mounted
- IP40 rated
- Programme time delay and lux settings via infrared handset
- Self contained unit
- Easy to install via a back plate
- 5 year warranty.

### Available control methods

- PRM – Switching
- DD – DALI/DSI dimming
- AD – Analogue dimming

### Detection pattern

high < sensitivity > low

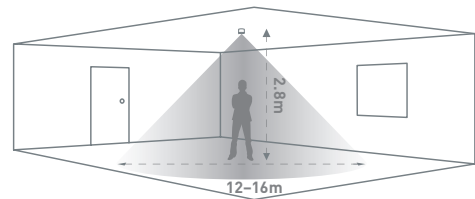

### Dimensions (mm)

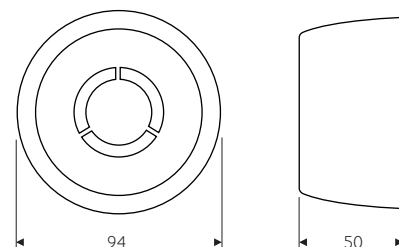



## MWS1A | Low profile, back box mounted detectors



This discrete range of wall or ceiling mounted microwave presence detectors is designed to fit any single gang switch box.

- Presence detection
- Programme time delay and lux settings via infrared handset
- Suitable for heating and ventilation applications
- Compatible with European back boxes
- Fixing screw cap covers – smooth plate finish
- 5 year warranty.

### Detection pattern

high < sensitivity > low

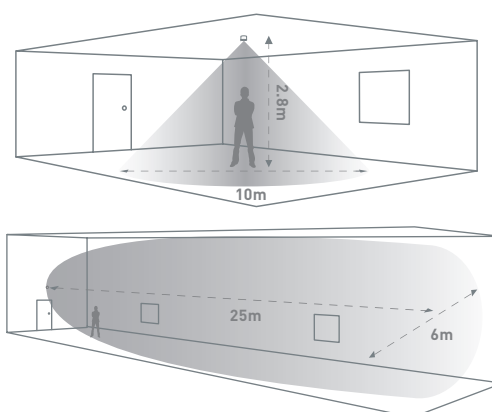

### Available control methods

- PRM – Switching

### Special order variants

- LV – Low voltage
- VFC – Voltage free contact

### Dimensions (mm)

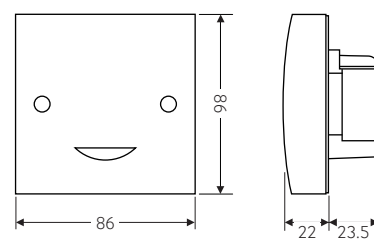

## MWS1A-IP | Rugged, surface mounted detectors



This rugged range of wall or ceiling mounted presence microwave detectors are rated IP66 – suitable for use in damp environments.

- Unobtrusive design – vandal resistant
- Programme time delay and lux settings via infrared handset
- Built in lux level sensing – enhanced energy saving
- Low voltage and volt free options – suitable for BMS and other control applications
- 5 year warranty.

### Detection pattern

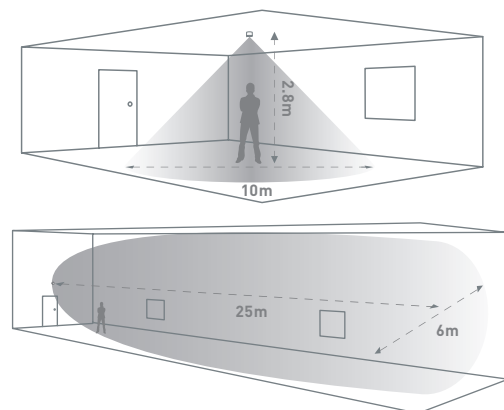

### Available control methods

- PRM – Switching

### Special order variants

- LV – Low voltage
- VFC – Volt free contact

### Dimensions (mm)

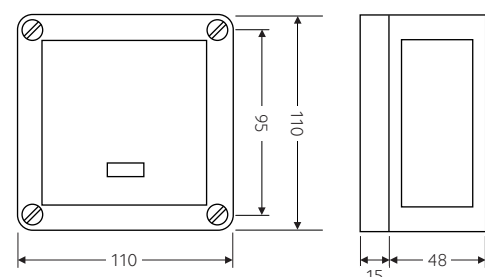

## ALC | Compact, flush mounted switching and dimming photocells



The ALC dimming photocell automatically adjusts the light output of luminaires depending on the amount of natural light available, to a maintained illuminance level.

- Flush or surface mounted
- Adjustable preset levels for more control
- Programme time delay and lux settings via infrared handset
- Dimming version available to provide a maintained level of illuminance
- 5 year warranty.

### Available control methods

- DD – DALI/DSI dimming
- AD – Analogue dimming

### Dimensions (mm)

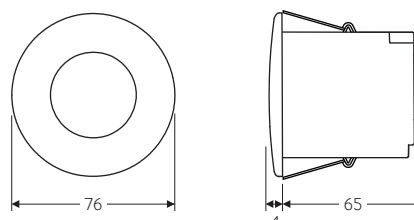



## Low Temperature Detectors

Following rigorous testing in climatic chambers and on-site, our Minus30 range of lighting controls is specifically designed for the cold storage and refrigeration sector, performing down to aggressive -30° temperatures.



## KNX Presence Detectors

CP Electronics brings its extensive functionality to KNX, the worldwide standard for unifying all communication between intelligent devices that light, heat and ventilate homes and buildings.

### Key features:

- Presence detector, either PIR or microwave
- Absence detection
- Walk test LED
- Light level sensor
- Two ELV switch inputs
- User-configurable logic functions and timers.

Configuration of devices on the KNX bus takes place via the standard ETS software application, allowing all aspects of the presence detector's behavior to be configured and controlled.



EBDSPIR-KNX



EBDHS-KNX



MWS3A-KNX



MWS6-KNX

## Presence and absence detection explained

The choice between presence and absence detection for different spaces can make a big difference in user-friendliness and the amount of energy saved.



**Presence Detection:** Detectors will switch on lighting automatically when a person enters the room, and switches off lighting automatically when no movement is detected.



**Absence Detection:** Upon entering the room the person switches on the light as normal, but on leaving the detector switches off the lighting automatically. Lights can also be switched off manually.

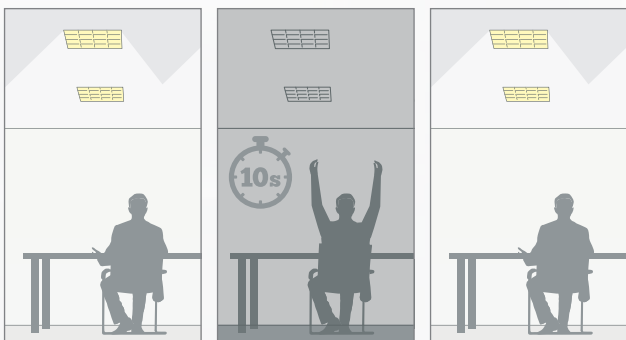

**Absence Recovery:** After an occupancy time out period has elapsed in absence mode, the unit temporarily enters a presence mode for 10 seconds allowing the occupants movement to bring the lights back on.



**Switch Detection Time:** This ensures that if a switch is activated and no movement is detected the lights will switch off after 10 seconds, minimising unnecessary lit space.

## PIRs and microwave detectors compared

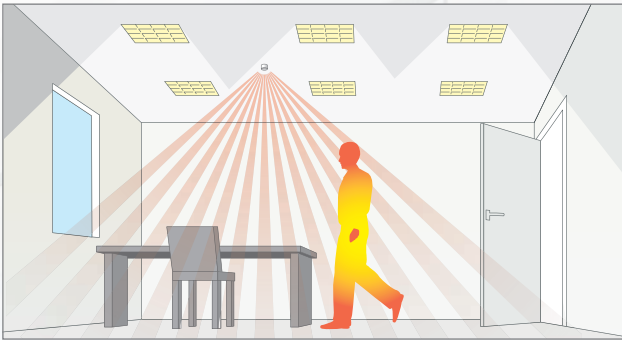

**PIR (Passive Infrared) Detection:** PIR detectors work on detecting the movement of body heat. They are better suited to smaller spaces or where a defined detection pattern is required.

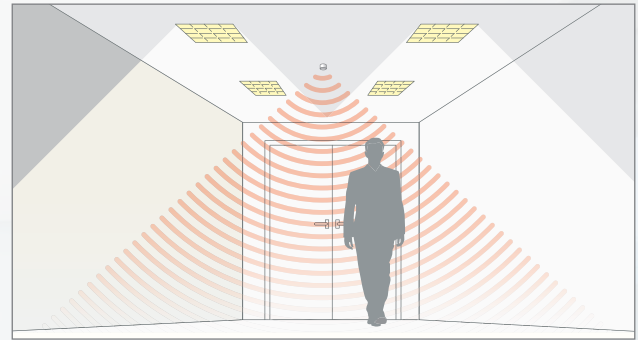

**Microwave Detection:** Microwave Detectors are sensitive to objects that move, with much greater coverage and sensitivity. They can detect through glass, therefore careful consideration on location is needed in certain applications.

## Walk towards & walk across explained (PIR Detectors)

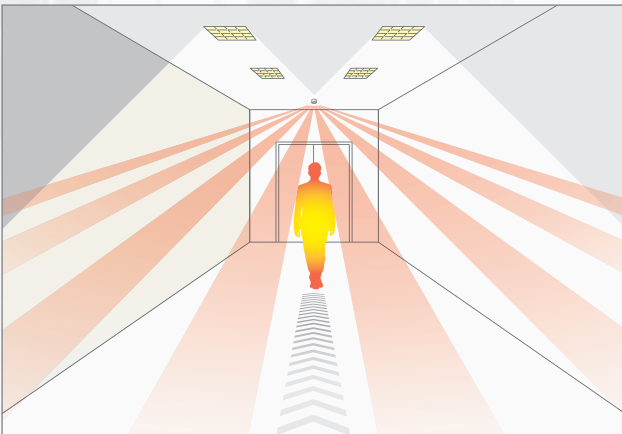

**Walking towards** the sensing area of a PIR detector may result in later detection as it is possible to walk towards the PIR sectors without crossing them (which is required for detection).



**Walking across** the detection area of a PIR detector results in a rapid detection because multiple sectors are crossed quickly triggering the detector.



## PRM Detectors | Switching with lux level sensing

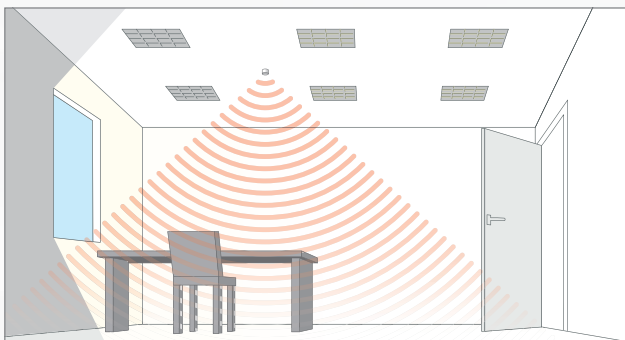

No presence detected, daylight, lights off.

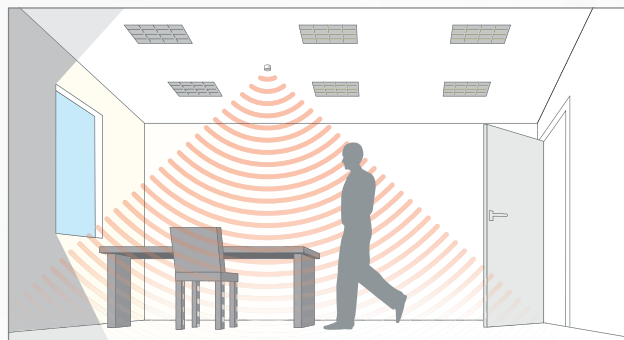

Presence detected, sufficient daylight, lights off.

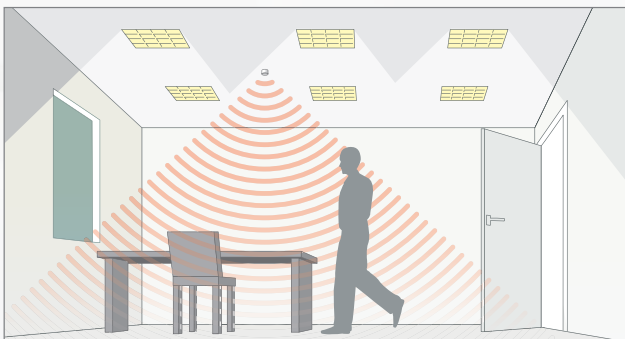

Presence detected, insufficient daylight, all lights on.

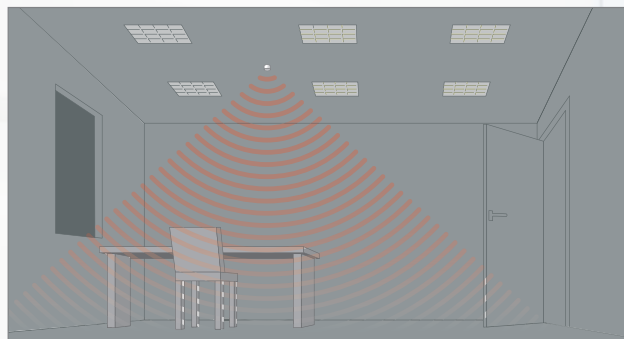

No presence detected, lights off.

These presence detectors have built-in adjustable lux sensors which will keep the lighting switched off if there is sufficient natural light.

### Key features

- Switching with lux level sensing (infrared handset adjustment)
- Active photocell
- Time delay function
- Presence detection switching.
- Absence detection switching
- Programmable via Infrared handset
- Adjustable detection sensitivity
- On/off override via optional Infrared handset
- Manual on/off override via switch input.

## DD & AD Detectors | Dimming with lux level sensing

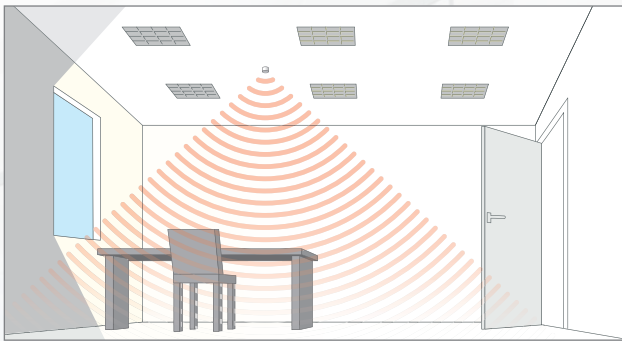

No presence detected, daylight, lights off.

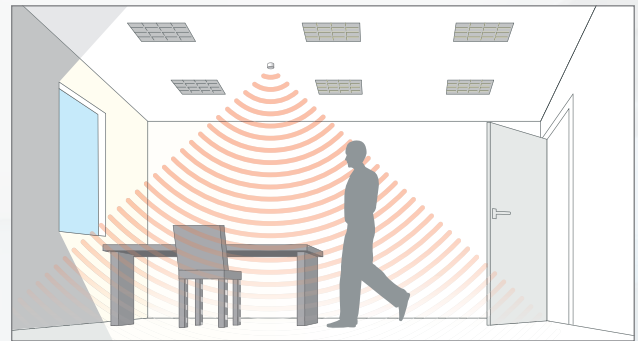

Presence detected, sufficient daylight, lights off.

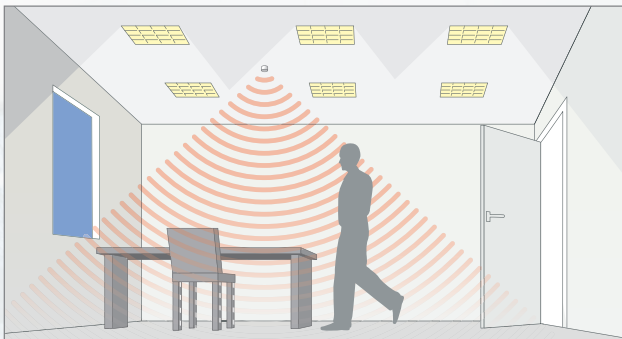

Presence detected, some daylight. Lights on and dimmed to maintain lux level.

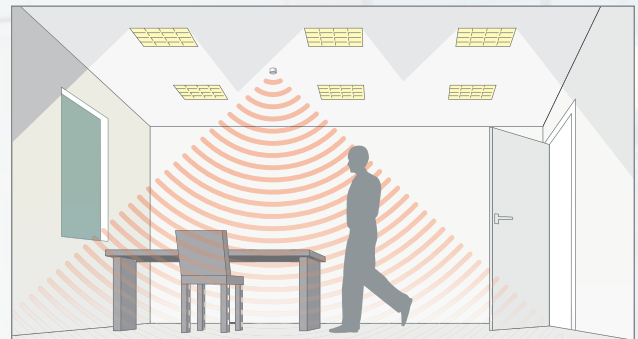

Presence detected, insufficient daylight. Detector measures and implements maintained illuminance.

These presence detectors have built-in adjustable lux sensors which will keep the lighting switched off if there is sufficient natural light.





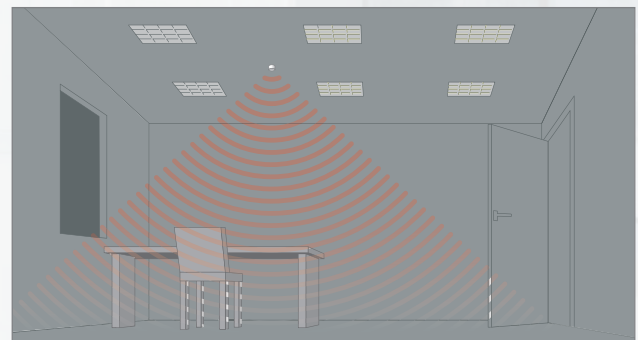

### Key features (in addition to PRM detectors)

- Dimming functionality
- Two channel flexibility
- Step-down illuminance
- Maintained illuminance (daylight harvesting)
- Scene setting and recall
- Burn in feature for fluorescent tubes
- Control of DALI, DSI or 1–10V loads depending on product
- Integral relay to reduce parasitic power
- Suitable for all lighting types
- Manual dimming with infrared
- Manual dimming with switch inputs.



No presence detected, lights off.

## Ceiling Mounted PIR Presence Detectors



	Order Code	Description	PG
	<b>EBDSPIR</b>	Basic switching, compact, IP40, flush mounted, PIR, presence detector	5
	<b>EBDSPIR-VFC</b>	Basic switching, compact, IP40, flush mounted, PIR, presence detector, volt free contact	
	<b>EBDSPIR-L3</b>	Basic switching, compact, IP40, flush mounted, PIR, presence detector, c/w 3m lead	
	<b>EBDSPIR-IP</b>	Basic switching, compact, IP55, flush mounted, PIR, presence detector	
	<b>EBDSPIR-AD</b>	1–10V analogue dimming, compact, IP40, flush mounted, PIR, presence/absence detector,	
	<b>EBDSPIR-DD</b>	DALI/DSI digital dimming, compact, IP40, flush mounted, PIR, presence/absence detector	
	<b>EBDSPIR-DD-LV</b>	DALI/DSI digital dimming, compact, IP40, flush mounted, PIR, presence/absence detector, low voltage	
	<b>EBDSPIR-PRM</b>	PRM switching, compact, IP40, flush mounted, PIR, presence/absence detector	
	<b>EBDSPIR-PRM-2CH</b>	PRM switching, compact, IP40, flush mounted, PIR, presence/absence detector, 2-channel	
	<b>EBDSPIR-PRM-2CH-NC</b>	PRM switching, compact, IP40, flush mounted, PIR, presence/absence detector, normally closed fail-safe contacts, 2-channel	
	<b>EBDSPIR-PRM-IP</b>	PRM switching, compact, IP55, flush mounted, PIR, presence/absence detector	
	<b>EBDSPIR-PRM-L3</b>	PRM switching, compact, IP40, flush mounted, PIR, presence/absence detector, c/w 3m lead	
	<b>EBDSPIR-PRM-LV</b>	PRM switching, compact, IP40, flush mounted, PIR, presence/absence detector, low voltage	
	<b>EBDSPIR-PRM-VFC</b>	PRM switching, compact, IP40, flush mounted, PIR, presence/absence detector, volt free contact	
	<b>EBDSM-AD</b>	1–10V analogue dimming, compact, IP54, surface mounted, PIR, presence/absence detector	6
	<b>EBDSM-DD</b>	DALI/DSI digital dimming, compact, IP54, surface mounted, PIR, presence/absence detector	
	<b>EBDSM-PRM</b>	PRM switching, compact, IP54, surface mounted, PIR, presence/absence detector	
	<b>EBMHS-AD-SA-C</b>	1–10V analogue dimming, miniature, IP40, flush/surface mounted, PIR, presence/absence detector, c/w pre-wired PSU	8
	<b>EBMHS-DD-SA-C</b>	DALI/DSI digital dimming, miniature, IP40, flush/surface mounted, PIR, presence/absence detector, c/w pre-wired PSU	
	<b>EBMHS-PRM-SA-C</b>	PRM switching, miniature, IP40, flush/surface mounted, PIR, presence/absence detector, c/w pre-wired PSU	
	<b>EBMPIR-MB-AD</b>	1–10V analogue dimming, miniature, retrofit, IP65, luminaire mounted, PIR, presence detector	9
	<b>EBMPIR-MB-DD</b>	DALI/DSI digital dimming, miniature, retrofit, IP65, luminaire mounted, PIR, presence detector	
	<b>EBMPIR-MB-PRM</b>	PRM switching, miniature, retrofit, IP65, luminaire mounted, PIR, presence detector	
	<b>EBMPIR-MB-PRM-110</b>	PRM switching, miniature, retrofit, IP65, luminaire mounted, PIR, presence detector, 110V	
	<b>EBDMR-PRM</b>	PRM switching, compact, mid range, IP40, flush mounted, PIR, presence/absence detector	7
	<b>EBDMR-DD</b>	DALI/DSI digital dimming, compact, mid range, IP40, flush mounted, PIR, presence/absence detector	
	<b>EBDMR-AD</b>	1–10v analogue dimming, mid range, IP40, flush mounted, PIR, presence/absence detector	
	<b>EBDRC-AD</b>	1–10v analogue dimming, adjustable head, long range, IP40, flush mounted, PIR, presence/absence detector	10
	<b>EBDRC-DD</b>	DALI/DSI digital dimming, adjustable head, long range, IP40, flush mounted, PIR, presence/absence detector	
	<b>EBDRC-PRM</b>	PRM switching, adjustable head, long range, IP40, flush mounted, PIR, presence/absence detector	

## Air Conditioning Controller







	Order Code	Description	PG
	<b>GESM-AC</b>	Surface mount PIR AC controller	13





## High Bay/High Level PIR Presence Detectors

	Order Code	Description	PG
	<b>EBDHS-AD</b>	1–10v analogue dimming, IP65, high bay/high level, flush mounted, PIR, presence/absence detector	11
	<b>EBDHS-DD</b>	DALI/DSI digital dimming, IP65, high bay/high level, flush mounted, PIR, presence/absence detector	
	<b>EBDHS-PRM</b>	PRM switching, IP65, high bay/high level, flush mounted, PIR, presence/absence detector	
	<b>EBDHS-MB-AD</b>	1–10v analogue dimming, retrofit, IP65, high bay/high level, luminaire mounted, PIR, presence detector	12
	<b>EBDHS-MB-DD</b>	DALI/DSI digital dimming, retrofit, IP65, high bay/high level, luminaire mounted, PIR, presence detector	
	<b>EBDHS-MB-PRM</b>	PRM switching, retrofit, IP65, high bay/high level, luminaire mounted, PIR, presence detector	





## Ceiling Mounted Microwave Presence Detectors

	Order Code	Description	PG
	<b>MWS1A-C-IP-PRM</b>	PRM switching, rugged, IP66, surface mounted, microwave, presence detector	19
	<b>MWS1A-C-IP-PRM-LV</b>	PRM switching, rugged, IP66, surface mounted, microwave, presence detector, low voltage	
	<b>MWS1A-C-IP-PRM-VFC</b>	PRM switching, rugged, IP66, surface mounted, microwave, presence detector, volt free contacts	
	<b>MWS1A-C-PRM</b>	PRM switching, low profile, IP40, back box mounted, microwave, presence detector	18
	<b>MWS1A-C-PRM-LV</b>	PRM switching, low profile, IP40, back box mounted, microwave, presence detector, low voltage	
	<b>MWS1A-C-PRM-VFC</b>	PRM switching, low profile, IP40, back box mounted, microwave, presence detector, volt free contacts	
	<b>MWS3A-AD</b>	1–10v analogue dimming, adjustable head, long range, IP40, flush mounted, microwave, presence/absence detector	14
	<b>MWS3A-AD-LV</b>	1–10v analogue dimming, adjustable head, long range, IP40, flush mounted, microwave, presence/absence detector, low voltage	
	<b>MWS3A-DD</b>	DALI/DSI digital dimming, adjustable head, long range, IP40, flush mounted, microwave, presence/absence detector	
	<b>MWS3A-DD-LV</b>	DALI/DSI digital dimming, adjustable head, long range, IP40, flush mounted, microwave, presence/absence detector, low voltage	
	<b>MWS3A-PRM</b>	PRM switching, adjustable head, long range, IP40, flush mounted, microwave, presence/absence detector	
	<b>MWS3A-PRM-L3</b>	PRM switching, adjustable head, long range, IP40, flush mounted, microwave, presence/absence detector, c/w 3m lead	
	<b>MWS3A-PRM-LV</b>	PRM switching, adjustable head, long range, IP40, flush mounted, microwave, presence/absence detector, low voltage	
	<b>MWS3A-PRM-VFC</b>	PRM switching, adjustable head, long range, IP40, flush mounted, microwave, presence/absence detector, volt free contact	
	<b>MWS5-AD-SA-C</b>	1–10v analogue dimming, miniature, IP40, flush mounted, microwave, presence/absence detector, c/w pre wired PSU	15
	<b>MWS5-DD-SA-C</b>	DALI/DSI digital dimming, miniature, IP40, flush mounted, microwave, presence/absence detector, c/w pre wired PSU	
	<b>MWS5-PRM-SA-C</b>	PRM switching, miniature, IP40, flush mounted, microwave, presence/absence detector, c/w pre wired PSU	
	<b>MWS6-AD</b>	1–10V analogue dimming, compact, IP40, flush mounted, microwave, presence/absence detector	16
	<b>MWS6-DD</b>	DALI/DSI digital dimming, compact, IP40, flush mounted, microwave, presence/absence detector	
	<b>MWS6-PRM</b>	PRM switching, compact, IP40, flush mounted, microwave, presence/absence detector	
	<b>MWS6-PRM-2CH</b>	PRM switching, compact, IP40, flush mounted, microwave, presence/absence detector, 2-channel	
	<b>MWS6-PRM-LV</b>	PRM switching, compact, IP40, flush mounted, microwave, presence/absence detector, low voltage	
	<b>MWS6-PRM-VFC</b>	PRM switching, compact, IP40, flush mounted, microwave, presence/absence detector, volt free contacts	
	<b>MWS6SM-AD</b>	1–10v analogue dimming, IP40, surface mounted, microwave, presence/absence detector	17
	<b>MWS6SM-DD</b>	DALI/DSI digital dimming, IP40, surface mounted, microwave, presence/absence detector	
	<b>MWS6SM-PRM</b>	PRM switching, IP40, surface mounted, microwave, presence/absence detector	





## Wall Mounted Microwave Presence Detectors

	Order Code	Description	PG
	<b>MWS1A-IP-PRM</b>	PRM switching, rugged, IP66, wall, surface mounted, microwave, presence detector	19
	<b>MWS1A-IP-PRM-LV</b>	PRM switching, rugged, IP66, wall, surface mounted, microwave, presence detector, low voltage	
	<b>MWS1A-IP-PRM-VFC</b>	PRM switching, rugged, IP66, wall, surface mounted, microwave, presence detector, volt free contacts	
	<b>MWS1A-PRM</b>	PRM switching, long range, IP40, wall, back box mounted, microwave, presence detector	18
	<b>MWS1A-PRM-LV</b>	PRM switching, long range, IP40, wall, back box mounted, microwave, presence detector, low voltage	
	<b>MWS1A-PRM-VFC</b>	PRM switching, long range, IP40, wall, back box mounted, microwave, presence detector, volt free contact	

## Minus30 Low Temperature Detector Range

	Order Code	Description	PG
	<b>EBDHS-AD-LT30</b>	1–10v analogue dimming, low temp, IP65, high bay/high level, flush mounted, PIR, presence/absence detector	11
	<b>EBDHS-DD-LT30</b>	DALI/DSI digital dimming, low temp, IP65, high bay/high level, flush mounted, PIR, presence/absence detector	
	<b>EBDHS-PRM-LT30</b>	PRM switching, low temp, IP65, high bay/high level, flush mounted, PIR, presence/absence detector	
	<b>EBDHS-MB-AD-LT30</b>	1–10v analogue dimming, retrofit, low temp, IP65, high bay/high level, luminaire mounted, PIR, presence detector	12
	<b>EBDHS-MB-DD-LT30</b>	DALI/DSI digital dimming, retrofit, low temp, IP65, high bay/high level, luminaire mounted, PIR, presence detector	
	<b>EBDHS-MB-PRM-LT30</b>	PRM switching, retrofit, low temp, IP65, high bay/high level, luminaire mounted, PIR, presence detector	
	<b>EBDSPIR-AD-IP-LT30</b>	1–10V analogue dimming, compact, low temp, IP55, flush mounted, PIR, presence/absence detector	5
	<b>EBDSPIR-DD-IP-LT30</b>	DALI/DSI digital dimming, compact, low temp, IP55, flush mounted, PIR, presence/absence detector	
	<b>EBDSPIR-PRM-IP-LT30</b>	PRM switching, compact, low temp, IP55, flush mounted, PIR, presence/absence detector	
	<b>EBMPIR-MB-AD-LT30</b>	1–10V analogue dimming, miniature, retrofit, low temp, IP65, luminaire mounted, PIR, presence detector	9
	<b>EBMPIR-MB-DD-LT30</b>	DALI/DSI digital dimming, miniature, retrofit, low temp, IP65, luminaire mounted, PIR, presence detector	
	<b>EBMPIR-MB-PRM-LT30</b>	PRM switching, miniature, retrofit, low temp, IP65, luminaire mounted, PIR, presence detector	



## KNX Presence Detectors

	Order Code	Description	PG
	<b>EBDHS-KNX</b>	KNX, IP65, high bay/high level, flush mounted, PIR, presence/absence detector	11
	<b>EBDSPIR-KNX</b>	KNX, compact, IP40, flush mounted, PIR, presence/absence detector	5
	<b>MWS3A-KNX</b>	KNX, adjustable head, long range, IP40, flush mounted, microwave, presence/absence detector	14
	<b>MWS6-KNX</b>	KNX, compact, IP40, flush mounted, microwave, presence/absence detector	16



## Light Level Controls

	Order Code	Description	PG
	<b>ALC-PRM-VFC</b>	Compact, IP40, flush mounted, photocell switch, PRM switching, volt free contacts	20
	<b>ALC-DD</b>	Compact, IP40, flush mounted, photocell switch, DALI/DSI digital dimming	
	<b>ALC-AD</b>	Compact, IP40, flush mounted, photocell switch, 1–10V analogue dimming	

## Infrared Handsets

	Order Code	Description	PG
	<b>UHS5</b>	Compact, programming/commissioning handset	4
	<b>UHS7</b>	Compact, user handset	4
	<b>UNLCDHS</b>	Professional, programming/commissioning LCD handset	4

## Accessories

	Order Code	Description
	<b>DBB</b>	Surface mount back box, white*
	<b>MWS3A-DBB</b>	MWS3A Surface mount back box BESA fixing, white*
	<b>DBB-EXT</b>	Surface mount back box extender BESA fixing, white*
	<b>MWS3A-DBB-EXT</b>	MWS3A Surface mount back box extender BESA fixing, white**
	<b>EBDHS-DBB-WBRKT</b>	EBDHS Wall mount bracket, white*
	<b>MWS3A-DBB-WBRKT</b>	MWS3A Wall mount bracket, white**
	<b>EBD-ENCIP1</b>	IP65 detector enclosure, grey*
	<b>EXD-HSC</b>	Extended wiring compartment for use with flush mounted detectors, white*
	<b>EBDSPIR-MS</b>	Adhesive masking shields (pack of 10), white
	<b>EBDHS-MS</b>	Masking shields
	<b>MWS3A-PPC</b>	Wall mount protective cover for use with wall mount bracket, clear

\*Compatible with EBDSPIR, EBDHS, ALC, MWS6 and EBDMR presence detectors.

\*\* Also suitable for EBDRC.