

Multimeter

MC330

Energy Meter

MC320



PROPERTIES

- Measurements of instantaneous values of 67 quantities (U, I, P, Q, S, PF, PA, f, φ, THD, MD-thermal ...) - only MC330
- 4 Energy counters
- Accuracy class U, I, P 0.5 (active energy Class 1)
- Frequency range from 16 Hz to 400 Hz
- Up to 2 tariff inputs (option)
- Up to 2 pulse or relay outputs (option)
- AC or Universal (option) power supply
- Graphical LCD; 128 x 64 dots with illumination
- Automatic range of nominal current (max. 12.5A) and voltage (option)
- User-adjustable display of measurements
- Multilingual support (13 languages)
- RS 485 communication up to 115,200 bit/s (option)
- User-friendly PC MiQen software for setting via RS485 or RS232 communication

DESCRIPTION

The meter is intended for measuring, analysing and monitoring single-phase or three-phase electrical power network. The meter records TRMS value according to the principle of fast sampling of voltage and current signals. A built-in microprocessor calculates measurands (voltage, current, frequency, energy, power, power factor, phase angles, etc.) from the measured signals.

USE

The meter is intended for monitoring and measuring electrical quantities of three-phase electric-energy distribution system. The MC330 and MC320 records energy like the electricity meter in all four quadrants in four tariffs. Up to 2 pulse outputs or 2 tariff inputs are available for measurements control. MC330 can use pulse output as alarm output. Outputs are available as relay or open collector outputs.



225.5 ₂ V U1
225.5 ₂ V U2
225.4 ₃ V U3

142.1 ₇ kW P
21.7 ₁ kvar Q
143.9 ₂ kVAR S

223.1 ₄ V U1
207.0 ₉ A I1
45.6 ₅ kW P1

226.47 V U1
209.50 V U2
208.44 V U3
145.48 mA I1
144.94 mA I2
115.47 mA I3
4.47 V P1
-10.03 V P2
-1.00 V P3
-10.00 V Q1
-10.00 V Q2
-10.00 V Q3
-10.00 V S1
-10.00 V S2
-10.00 V S3

1 1217.819 Wh
2 357.693 Wh

+0.761 PF
+39.84° φ

0.116 ₅ A Iavg
0.34 ₃ A Inc

COMPLIANCE WITH STANDARDS:

Standard SIST EN	Description
61010-1	Safety requirements for electrical equipment for measurement, control and laboratory use
50470*	Electricity metering equipment
60529	Degrees of protection provided by enclosures (IP code)
62052-11 62052-21	Electricity metering equipment – General requirements, tests and test conditions

* - Partial compliance



DESCRIPTION OF PROPERTIES

MEASURANDS

RMS values of currents and voltages (only MC330)
Measurements of active, reactive, apparent power and power factor (only MC330)
Measurements of energy in all 4 quadrants
Average values of measurands per interval (only MC330)

INPUT / OUTPUT MODULES

The modules are available with double inputs/outputs. Each module has three terminals.

The meter is available without, with one or with two modules. The following modules are available:

- Output module (relay version MC330 only) 2 outputs
- Tariff input 2 inputs

Output module is available as:

Opto output according EN62053-31:2001 (27V, 27mA)

Relay output in MC330 can be used for pulse output or alarm output (40V, 1A)

COMMUNICATION

Option is communication module for reading measured values and instrument setting. Available is RS232 or RS485 communication type module. Communication is galvanic separated from other circuits. For setting we suggest using MIQEN software.

SUPPLY

Power supply connection of the meters (MC) is adaptive. Standard is AC power supply enables connection of the meter to AC voltage (57.7 & 63.5 / 100 & 110 / 230 / 400).

Option is a universal power supply enables connection of the meter to DC (20–300 V) or AC voltage (48–230 V / 50 Hz).

MIQEN

MiQen software is intended for supervision of the meter on PC. It enables setting meter parameters that are transferred into the instrument via communication (option). Multilingual software functions on Windows 98, 2000, NT, XP operating systems.

DATA DISPLAY

Data are displayed on 128 x 64 dot graphic LCD with illumination (37 x 69 mm). An indication symbol's on the front side are optical LED for energy flow and active alarm (MC330 only).

TECHNICAL DATA

EU DIRECTIVES:

Decree on electrical equipment designed for use within certain voltage limits **URLRS 53/00**
(Directive **2006/95/EC** on low voltage):

SIST EN 61010-1: 2002

Safety requirements for electrical equipment for measurement, control and laboratory use, part 1: General requirements

Decree on electromagnetic compatibility (EMC)

URLRS 61/00

(Directive **2004/108/EC** on electromagnetic compatibility):

SIST EN 62052-11 : 2004

Meters for active energy (class 1).

SAFETY:

Protection: protection class **II**
600 V rms, installation category **II**
300 V rms, installation category **III**
pollution degree 2

in compliance with **SIST EN 61010-1**: 2002

Enclosure material: PC/ABS

incombustibility–self-extinguishability,

complying with **UL 94 V-0**

Enclosure protection: IP 52 (IP 00 for terminals)

in compliance with **SIST EN 60529**: 1997

Cutting for installation: 92^{+0,8} mm

Converter mass: max.. 500 g

AMBIENT CONDITIONS:

Climatic class: 3

in compliance with **SIST EN 62052-11**: 2004

in compliance with **SIST EN 62052-21**: 2005

Temperature range of operation: -10 to +55°C

Storage temperature range: -40 to +70°C

Average annual humidity: ≤ 75% r.h.

INPUTS

Input signals	Current	Voltage
Nominal frequency range	50, 60 Hz	
Measuring frequency range	16 –400 Hz	
Nominal value (In, Un)	5 A	500 V _{L-N}
Maximal vale	12.5 A	750 V _{L-N}
Consumption	< 0.1 VA	< 0.1 VA

POWER SUPPLY

Power supply	Universal	AC
Nominal voltage AC	48–230 V	57.7 & 63.5 / 100 & 110 / 230 / 400
Nominal frequency	40–65 Hz	40–65 Hz
Nominal voltage DC	20–300 V	–
Consumption	< 5 VA	< 5 VA

REFERENCE CONDITIONS

Ambient temperature: -10... 23 ... 55°C

Voltage input: +/- 20% Un

Voltage input with voltage autorange 50...500 V

Current input0... 100 % In

Active/reactive power, factor: cosφ =1 / sinφ =1

Waveform: Sinus

ACCURACY

Accuracy is presented as percentage from nominal value of the measurand except when it is stated as an absolute value.

Measurand		Accuracy
Rms current (I1, I2, I3, Iavg, In, MD)		0.5
Rms phase voltage (U1, U2, U3, Uavg, MD)	62.5–750 V 10–500 V	0.5
Phase-to-phase voltage (U12, U23, U31, Uavg)		0.5
Frequency (f)		10 mHz
Power factor (PF)		0.5
Phase and phase-to-phase angle (φ , φ_{12} , φ_{23} , φ_{31})		0.5°

Measurand		Accuracy
Active, reactive and apparent power		0.5
Active energy	SIST EN 62053-21	Class 1
Reactive energy	SIST EN 62052-23	Class 2
Pulse output	SIST EN 62053-31	Class A & B

CONNECTION

Converter voltage inputs can be connected either directly to low-voltage network or via a high-voltage transformer to high-voltage network. Current inputs shall be connected to network via a corresponding current transformer.

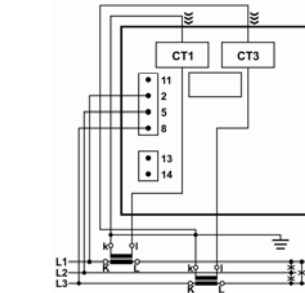

3u – three-wire, uniform load

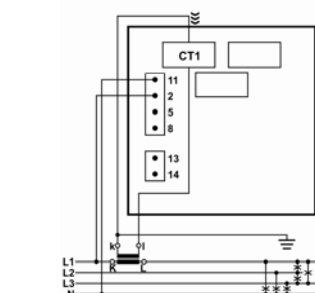

4b – four-wire, uniform load

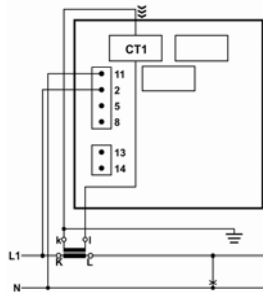

1b – single-wire, uniform load

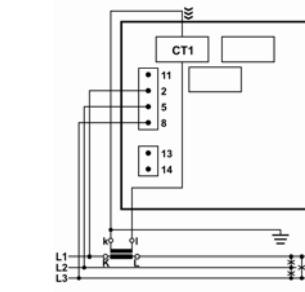

3b – three-wire, non-uniform load

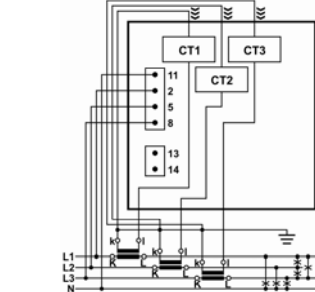

4u – four-wire, non-uniform load

Inputs / Quantities		Terminals	
Measuring inputs:	AC current	IL1	TT1
		IL2	TT2
		IL3	TT3
	AC voltage	UL1	2
		UL2	5
		UL3	8
Auxiliary power supply:		N	11
		+ / AC	13
		- / AC	14
Input / Output modules	Output	Out -1	15
		C-12	16
		Out -2	17
	Tariff input	T 1/2	18
		C	19
		T 3/4	21

DIMENSIONAL DRAWING

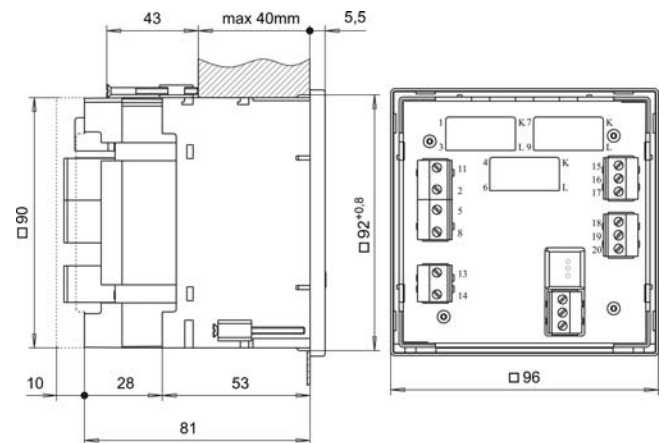

TERMINALS

Connection	Max. conductor cross-sections
Voltage inputs (4)	≤ 2.5 mm ² ; one conductor
Current inputs (3)	≤ Ø 6 mm; one conductor with insulation
Power supply (2)	≤ 2.5 mm ² ; one conductor
Modules (2 x 3)	≤ 2.5 mm ² ; one conductor

DATA FOR ORDERING

Measuring centre:

The following data shall be stated:

- Type of a meter
- Voltage range
- Type of power supply
- Type of a module
- Communication

Supplement:

- MiQen software

ORDERING

When ordering the meter, all required specifications shall be stated in compliance with the ordering code.

The meters automatic range of input current (up to 5 A) is not stated in the code.

EXAMPLE OF ORDERING:

The MC3X0 meter is connected to secondary phase voltage up to 500 V_{L-N} and 5 A secondary current. A universal supply and two modules are built-in the meter. The first module is an relay output and the second one is a tariff input. Meter is without communication.

Ordering code:

MC330-AV-EDC/AC-2RO/2TI

GENERAL ORDERING CODE

All specifications are obligatory

An example of a completely filled-in ordering code:

MC330/240V/EDC/AC-2RO/2TI-RS485

Meter type

MC330

MC320

Voltage range (UIn)

AV automatic range 50...500V

63V 57.7 V and 63.5 V

100V 110V

240V 230V and 240 V

Power supply

EDC/AC Universal

E57/63V 57.7 V / 63.5 V AC

E100/110V 100 V / 110 V AC

E230/240V 230 V / 240V AC

E400V 400 V AC

Module 1 /

WO Without

2S0 2 X opto output

2RO 2 X Relay output (MC330 only)

Module 2

WO Without

2TI 2 X Tariff input

Comm. RS485 or RS232 module (Optional)

WO Without

RS485 RS485 communication

RS232 RS232 communication

Dictionary:

RMS

Root Means Square

PA

Power angle (between current and voltage)

PF

Power factor

MiQen

Software for MC meters

AC

Alternating quantity



Management Service



Iskra MIS, d.d.

Ljubljanska c. 24a, SI-4000 Kranj, Slovenia

Tel.: +386 4 237 21 12, Fax: +386 4 237 21 29

E-mail: info@iskra-mis.si, www.iskra-mis.si

